

NOTE: BAR PLACEMENT
CANADA REFER TO CCMC # 13043-R
U.S. REFER TO ICC-ESR-1269

OR LOCAL BUILDING CODE
OR PROFESSIONAL ENGINEER
REQUIREMENTS

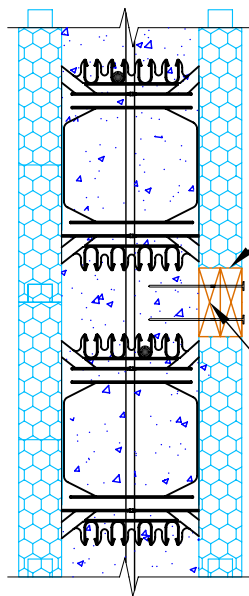

REMOVE PORTION OF FORM
TO FACE OF CONCRETE
AFTER CONCRETE POUR

INSTALL WOOD BLOCKING OR
PLYWOOD BACKING TO CONCRETE
WITH CONCRETE FASTENERS



Website: www.amvicsystem.com

AMVIC INC.
501 McNicoll Avenue
Toronto, ON M2H 2E2
Canada
Toll Free: 877-470-9991
Fax: 416-759-7402

MODERATE HANGING LOAD DETAIL

Drawing Scale:	1" = 1'-0"
Creation Date:	JULY, 2004
Revision:	—
Drawing ID Number:	AMV-HAN-002

ALL DETAILS SHALL BE CONSTRUCTED IN ACCORDANCE WITH LOCAL BUILDING CODES AND PRACTICES. AMVIC INC. RESERVES THE RIGHT TO CHANGE INFORMATION SHOWN WITHOUT NOTICE.