

1 - DETAILS IN THIS DRAWING ARE INTENDED AS AN AID FOR THE DESIGN PROFESSIONAL AND SHALL NOT BE USED FOR CONSTRUCTION UNTIL APPROVED BY A LOCAL LICENSED/REGISTERED ENGINEER.

2 - A QUALIFIED PROFESSIONAL SHALL DESIGN TEMPORARY SHORING AS PER LOCAL CODE REQUIREMENTS.
(ACI 347 FOR USA OR CAN/CSA-S269.3 FOR CANADA)

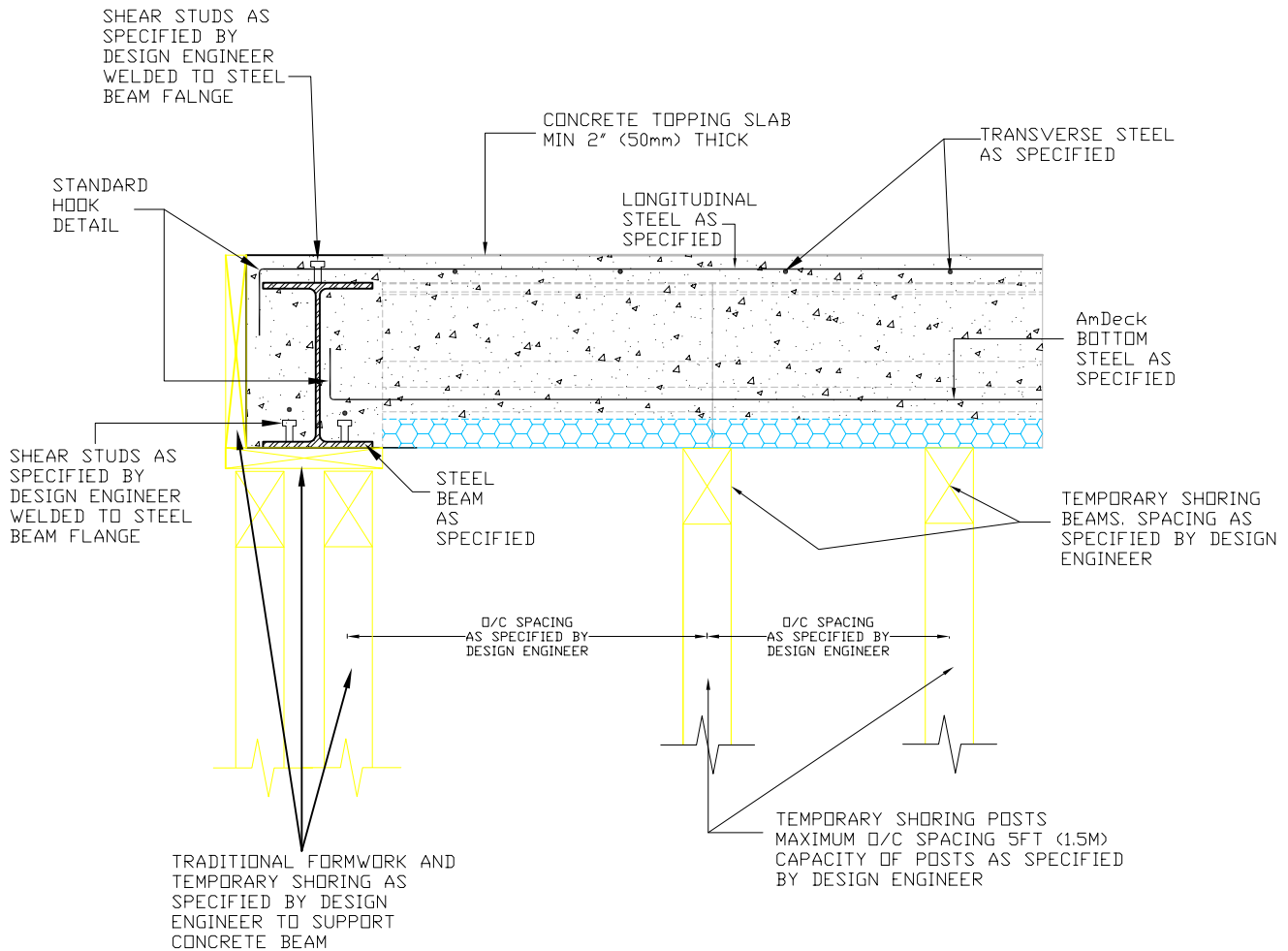

Website: www.amvicsystem.com

AMVIC INC.
501 McNicoll Avenue
Toronto, ON M2H 2E2
Canada
Toll Free: 877-470-9991
Fax: 416-759-7402

AmDeck CONNECTION TO COMPOSITE PERIMETER BEAM FLUSH AT BOTTOM (LONGITUDINAL SECTION)

Drawing Scale:	1" = 1'-0"
Creation Date:	MAY. 2006
Item Number:	
Drawing ID Number:	AMD-CON-24

ALL DETAILS SHALL BE CONSTRUCTED IN ACCORDANCE WITH LOCAL BUILDING CODES AND PRACTICES. AMVIC INC. RESERVES THE RIGHT TO CHANGE INFORMATION SHOWN WITHOUT NOTICE.