

# ICF Construction Accessories

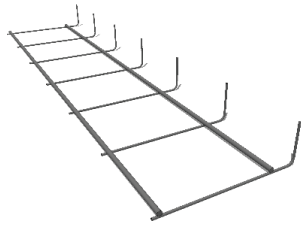

## Amvic - Brick Ledge Reinforcer

The Amvic Brick Ledge Reinforcer is an engineered ICF brick ledge reinforcement system that is designed to replace conventional rebar in brick ledge forms. It is a single pre-assembled, 4ft (1.2m) long deformed welded wire reinforcement piece that is placed directly into Amvic's brick ledge. It is compatible with the R22 ICF brick ledge forms in both 6" (152mm) and 8" (203mm), the R30 6" (152mm) brick ledge and the fabricated brick ledge extensions (for both R22 and R30 ICF). Once placed in the ICF form, the Amvic Reinforcer does not need to be lapped or tied to each other.

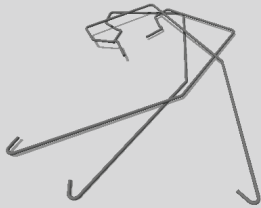

## Amvic - HV Hooks

HV Hooks are an all-in-one metal wire clip designed to replace conventional nylon cable ties in ICF construction. The hooks are designed with seven bends to provide it with simultaneous horizontal and vertical locking capacity. It is available in two sizes; HV22 for Amvic's Standard ICF (6" (152mm) web spacing) and HV30 for Plus ICF forms (8" (203mm) web spacing).

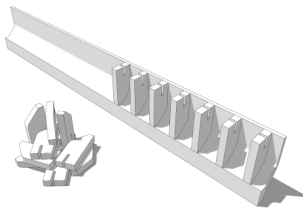

## Amvic - Brick Ledge Extension

The Brick Ledge Extension is designed to support masonry veneer exterior finishes where using a specialty brick ledge ICF block is not possible. It is made from the same EPS as the ICF blocks and is compatible with Amvic's R22 and R30 blocks in all core sizes. It can be installed at any height, angle and side of an ICF wall. It comes fully dismantled in compact packaging to save space and cost during shipping. Each kit contains one ledge and either 12 (for R30 ICF) or 16 (for R22 ICF) inserts.



## Amvic - Brick Ledge Extension Fastening Kit

To be used with Bridge Ledge Extension. This kit is composed from 1000 assembled fasteners (500 fasteners with 4" (102mm) screws and 500 fasteners with 6" (152mm) screws). The fasteners are installed through the foam into the ICF polypropylene webs. Can be installed in all weather conditions. One kit is sufficient for 248 linear feet (75.6m) or 31 panels for the R22 Brick Ledge Extension or 328 linear feet (100m) or 41 panels for the R30 Brick Ledge Extension.



## Amvic - Zip Ties

Nylon zip ties are a cost-effective method for quick and easy securement of ICF blocks together, either in a vertical or horizontal configuration. Each cable tie is rated for 175lb (79kg) of tensile strength with a long and proven track record in ICF construction. The black ties are UV treated and available in 36" (0.9m) and 48" (1.2m) lengths.

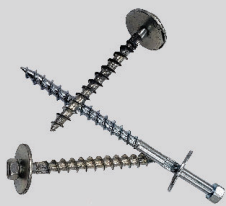

## Amvic - ICF Screws

Amvic's ICF screws are hardened and galvanized to offers superior all-weather performance and durability. The coarse thread works well with the plastic ICF webs with increased holding capacity and pullout strength. The combination of the hex head and the loose washer makes for a quick and easy screw removal. In addition, the loose washer prevents screws from being recessed into lumber when fastening to the web of an ICF form. Available in 2" (51mm) or 3" (76mm) lengths.

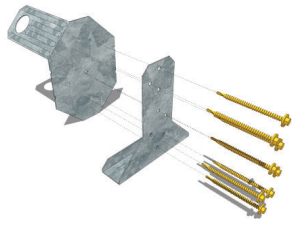

**Simpson Strong-Tie - ICFVL**

The ICFVL connector system by Simpson Strong-Tie is an engineered floor mounting system for ICF construction. It is designed to provide both vertical and lateral in-plane performance. The system replaces the need for traditional anchor bolts with better on-center spacing, faster and easier installation and no protrusions. The system is composed of two primary components, ICFVL (base plate) and ICFVL-W (for two-by lumber) or ICFVL-CW (for laminated veneer lumber).

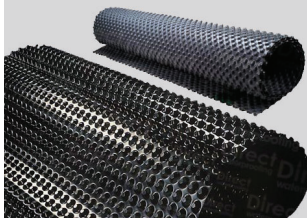

**Aqua Q - Platon Foundation Wrap**

Platon is a rugged, dimpled high-density polyethylene (HDPE) membrane for below grade foundation walls. If any moisture does find its way past the membrane, it is carried to the foundation drain by the provided air gap drainage path. It is economical and easy to install in any weather condition with the ability to easily bridge cracks of up to 1/4" (6mm) in width. An ideal solution to be used in conjunction with a peel-and-stick membrane on ICF foundations.

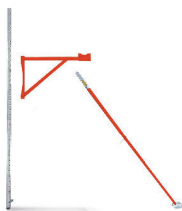

**Plumwall - ICF Bracing System**

Plumwall provides a complete bracing system for ICF construction for quick, accurate and professional installations. The unique one-man alignment control is located at the platform level making it ideal for adjustments of freshly poured concrete. This highly durable and flexible system can be configured for tall wall applications and is available in either All-In-One or 3-Piece configurations.



**DuROCK - B2000**

B2000 is an acrylic-modified cementitious dry mix base coat designed for use over Expanded Polystyrene (EPS) Insulated Concrete Forms (ICF). It forms a strong but flexible crack resistant base coat that is intended for use on the exterior, above grade portion of ICF foundation walls. It has high flexural and bond strength, is vapor permeable, with low water absorption and excellent freeze-thaw resistance.

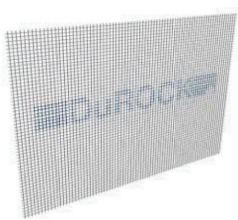

**DuROCK - Fiberglass Mesh**

DuRock's Fiberglass Mesh is a 5oz (142g) high impact alkali-resistant fiberglass mesh designed to be used with B2000 paring base coat. Provides increased flexural strength to the base coat while improving the bond to the substrate. It comes in rolls of 39"x144' (1m x 44m).



**SOPREMA - Colphene ICF**

Colphene ICF is a peel-and-stick membrane composed of SBS modified bitumen and silicone release film. The membrane is designed to be used for either waterproofing or damp proofing for below grade ICF foundation walls. It can be installed with or without primer over clean and dry ICF walls. It comes in rolls of 36in x 75ft (0.9m x 22.9m). Colphene ICF is available in two grades, summer and winter, with application temperatures of 50-122°F (10-50°C) and 14-50°F (-10-10°C) respectively.



**SOPREMA - Elastocol Stick H2O**

Elastocol Stick H2O is a single component water based primer designed to be used in conjunction with self-adhering waterproofing membranes on most substrates. It is an excellent choice when the use of solvent based primer is not recommended. Can be applied with either a brush, spray gun or a roller.

