

WHAT IS AMDRY?

MOST BASEMENTS HAVE MOISTURE PROBLEMS

Amdry is a one-step insulated subfloor system with a moisture resistant protective surface film. It provides a healthy, comfortable, warm basement by significantly reducing slab surface moisture and temperature fluctuations that may lead to mold and mildew problems.

PRODUCT APPLICATIONS

- Concrete Floors
- Exercise Rooms
- Workshops
- Home Theatres
- Garage Floors
- Play Rooms

Can be used with most floor finishes e.g. carpet, laminate or hardwood.



BEFORE



AFTER

REQUIRED TOOLS

Rubber mallet and tapping block, cutting saw, tape measure, utility knife and 1/2" spacer blocks.

INSTALLATION TIPS



STEP 1 Place 1/2" spacers, starting in one corner. Align the first Amdry panel against the spacer boards.



STEP 2 Insert the connector by hand into the end of the Amdry panel and place the next panel.



STEP 3 With a row of panels completed, begin the next row making sure to stagger panels.

FOR DETAILED INSTALLATION
INFORMATION VISIT:
AMDRYSUBFLOOR.COM



WARMER, DRYER, AND MORE ENERGY EFFICIENT BASEMENTS

Introducing Amdry, the only insulated subfloor panel with integrated moisture resistant film and raised drainage channels.



WARMER, DRIER, MORE ENERGY EFFICIENT



ENERGY EFFICIENT

High quality EPS foam insulation makes Amdry subfloor panels more energy efficient than competitive products.

DRIER BASEMENT

Deep drainage and ventilation channels covered with a moisture resistant protective film allow continuous air flow and evaporation, keeping your basement drier and warmer.

The film also protects the foam insulation and OSB, preventing moisture absorption which reduces the potential for mold and mildew.

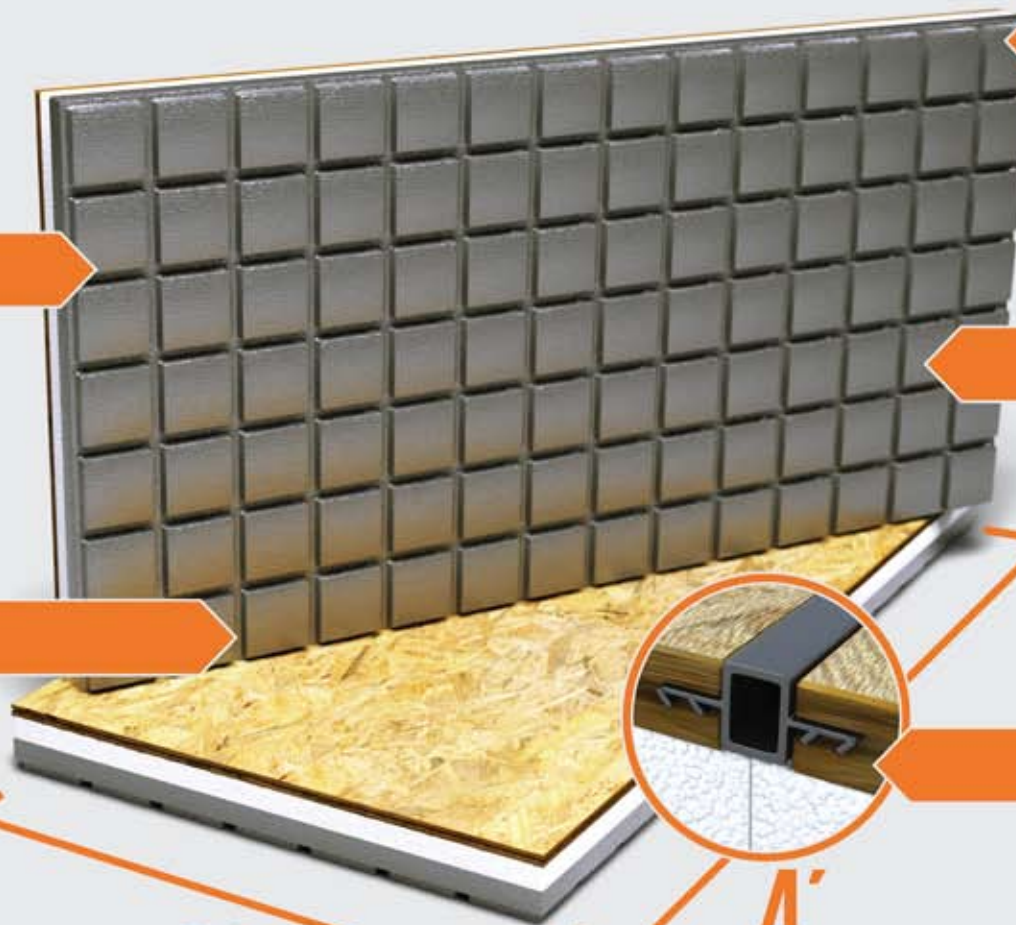

EASY INSTALLATION

Amdry panels are installed quickly and easily. Amdry's unique connector system allows panels to effortlessly lock together, without the need for nails or glue. A 1000 sq. ft. basement can be installed by one person in less than 7 hours.*

LARGER PANELS

24" x 48" Amdry panels each provide a full 8 sq. ft. of surface coverage, unlike competitive panels which are only 23.25" x 23.25" (3.75 sq ft). Amdry's panels require 40% less installation time and labour than competitive products. Amdry's larger panels also better accommodate irregularities and minor slopes often found on basement floors.

CONNECTOR SYSTEM

The Amdry connectors are inserted into the edge grooves of each panel. The system is engineered to provide a secure, tight connection. These unique connectors eliminate tongue-and-groove joints which often lead to squeaking floors and can be easily damaged before, during or after installation.

Amdry becomes a single continuous thermal insulated subfloor assembly, that provides outstanding moisture drainage and drying properties.

*The length of installation time will vary by the room layout complexity.