



WATERPROOFING

# COLPHENE® ICF FOUNDATIONS



SELF-ADHESIVE MEMBRANE DESIGNED SPECIFICALLY FOR DAMPROOFING AND WATERPROOFING OF INSULATED CONCRETE FORM (ICF) FOUNDATIONS

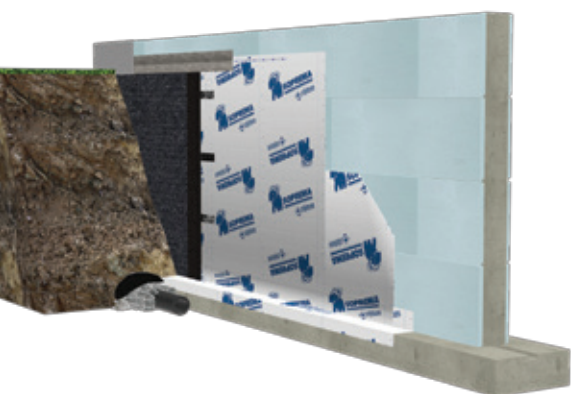

COLPHENE ICF is a high quality self-adhesive membrane composed of SBS modified bitumen and a tri-laminate woven polyethylene facer. The membrane provides damproofing and waterproofing on ICF formwork systems.

- Superior flexibility
- Puncture resistant with high tensile strength
- Consistent thickness

## SURFACE PREPARATION

COLPHENE ICF can generally be installed without primer over clean, dry ICF surfaces requiring damproofing. Consult your SOPREMA representative if COLPHENE ICF is intended to be used for waterproofing (primer will be required) or if specific conditions call for the use of primer. If primer is required, use ELASTOCOL STICK H<sub>2</sub>O water-based primer.

## COMPLEMENTARY PRODUCTS

### ELASTOCOL STICK H2O

is a polymer emulsion-based primer designed to improve the adhesion of self-adhesive membranes on most substrates.

### SOPRASEAL LM 200 T

is a water-based sealing compound used at the top termination of COLPHENE ICF.

### SOPRAGRIP F

is a self-adhesive membrane composed of SBS modified bitumen and a non-woven polyester exposed reinforcement. It can be used as a cover strip over the top termination of COLPHENE ICF.

COLPHENE ICF	
THICKNESS	1 mm (40 mil)
DIMENSIONS	36 in x 75 ft (0.91 m x 22.9 m)
SURFACE	Tri-laminated woven polyethylen
UNDERFACE	Silicone release film

See Evaluation Report CCMC 13630-R (for waterproofing) and Evaluation Report CCMC 14080-R (for damproofing).



SOPREMA.CA

1 877 MAMMOUTH

## INSTALLATION INSTRUCTIONS

1



Install the footing membrane first, making sure that the inside corner is completely adhered.

2



Peel back the top part of the silicone release paper, making sure the membrane is well aligned.

3



Gradually peel back the remaining silicone release paper, making sure the membrane is completely adhered.

4



The use of a roller is required to apply a uniform pressure over the entire membrane surface.

5



Seal membrane's top termination with a mastic/sealant such as SOPRASEAL LM 200 T. The use of a termination bar mechanically fastened to ICF is recommended at membrane's top termination.

### Backfill:

In areas where pit-run sand is not available, a protective board is recommended to ensure the integrity of the membrane.

If you have any questions about this product or its installation, please contact your SOPREMA representative.